



9 4 J A C K S O N R O A D S U I T E 1 1 0 , D E V E N S , M A 0 1 4 3 4

TERMINATIONS

Model RMTE75.1000Bm5

BNC male, Screw-on

FREQUENCY (MHz)	POWER (WATT)(avg)	IMPEDANCE (Ω)	VSWR (max)	WEIGHT (grams)
DC-1000	5	75	1.20:1	50

Notes:

a. Case Materials/Plating:

Housing: Brass w/nickel plate

Contact: brass w/gold plate

Insulator: PTFE

b. Operation temperature: -55°C to +125°C deg

c. Power rated @ 25°C ambient and derates linearly to 0.5W @ 125°C

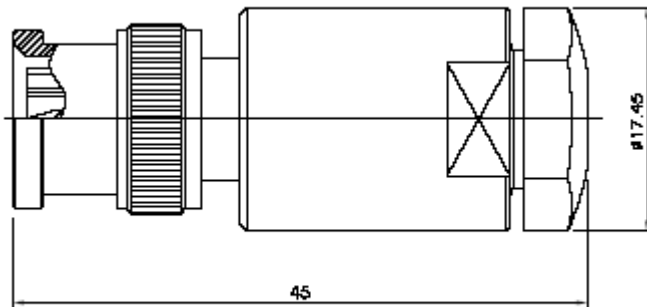

All specifications are subject to change without notice.

Telephone: 978-772-3767
772-3768

Fax: 978-

www.responsemicrowave.com