



9 4 J A C K S O N R O A D , S U I T E 1 1 0 , D E V E N S , M A 0 1 4 3 4

TERMINATIONS

Model RMTE.40000KmC1
2.92mm male, 2" monel bead chain w/ eyelet

FREQUENCY (MHz)	POWER (WATT)(max)	IMPEDANCE (Ω)	VSWR (max)
DC-40000	1	50	1.25:1

Notes:

- a. Case Materials/Plating:
 Housing: 303 stainless/passivate
 Center Contact: BeCU/gold
 Insulator: PTFE
 O-ring: Silicone Rubber
- b. Operation temperature: -40C to +120C deg
- c. Add "C" suffix for 2" monel bead chain w/eyelet

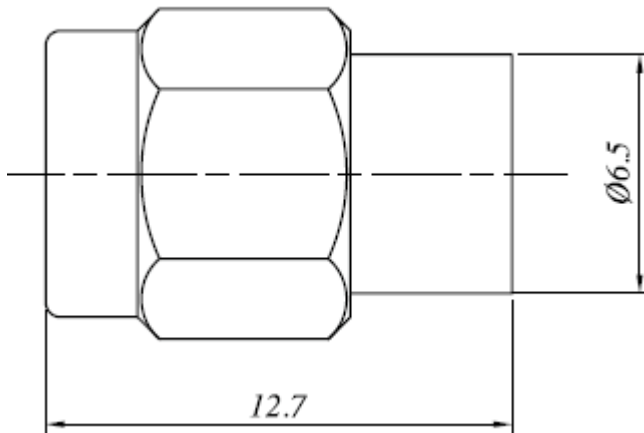

All specifications are subject to change without notice.

Telephone: 978-772-3767
 772-3768

Fax: 978-

www.responsemicrowave.com