



9 4 J A C K S O N R O A D , S U I T E 1 1 0 , D E V E N S , M A 0 1 4 3 4

## TERMINATIONS

Model RMTE.27000Sm2

SMA male

| FREQUENCY<br>(MHz) | POWER<br>(WATT)(max) | IMPEDANCE<br>( $\Omega$ ) | VSWR<br>(max) |
|--------------------|----------------------|---------------------------|---------------|
| DC-27000           | 2                    | 50                        | 1.25:1        |

### Notes:

- Case Materials/Plating:  
Housing: 303 stainless/passivate  
Center Contact: BeCU/gold  
Insulator: PTFE  
O-ring: Silicone Rubber
- Operation temperature: -40C to +120C deg
- Add "C" suffix for 2" monel bead chain w/eyelet

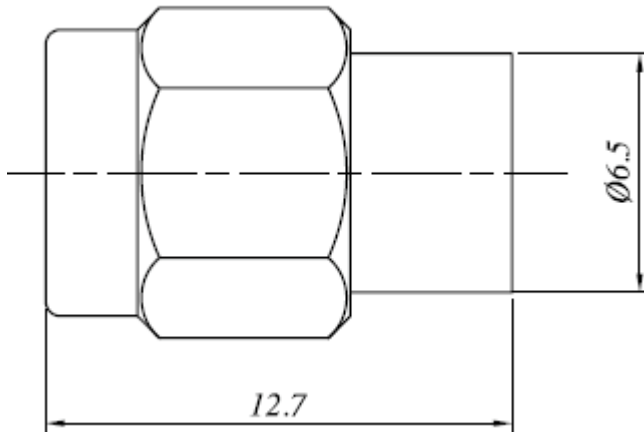

*Dimensions in mm. All specifications are subject to change without notice.*

Telephone: 978-772-3767  
772-3768

Fax: 978-

[www.responsemicrowave.com](http://www.responsemicrowave.com)