



9 4 J A C K S O N R O A D , S U I T E 1 1 0 , D E V E N S , M A 0 1 4 3 4

TERMINATIONS

Model RMTE.27000Sm1

SMA male

FREQUENCY (MHz)	POWER (WATT)(max)	IMPEDANCE (Ω)	VSWR (max)
DC-27000	1	50	1.25:1

Notes:

- Case Materials/Plating:
Housing: 303 stainless/passivate
Center Contact: BeCU/gold
Insulator: PTFE
O-ring: Silicone Rubber
- Operation temperature: -40C to +120C deg
- Add "C" suffix for 2" monel bead chain w/eyelet

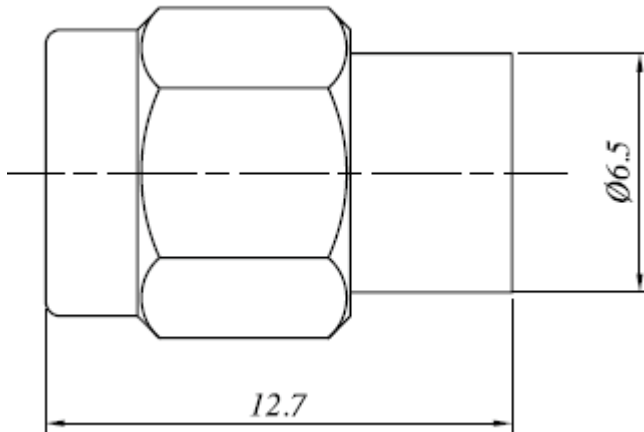

Dimensions in mm. All specifications are subject to change without notice.

Telephone: 978-772-3767
772-3768

Fax: 978-

www.responsemicrowave.com