



94 JACKSON ROAD, SUITE 110, DEVENS, MA 01434 USA

## Power Divider / Splitters

Model RMPD2.2200Nf

2-way Power Divider N female

Frequency (MHz)	Insertion Loss (dB max)	Isolation (dB min)	VSWR	Phase Balance (°) max	Amplitude Balance (dB) max
800 - 2200	0.4	22	1.20/1.25 typ 1.35:1 max	2	0.1

### Notes:

- Input and output impedance: 50 Ohms
- Connector: N female, (options: SMA, BNC, TNC & Reverse Polarity versions)
- Power: Input – 25W Output - ≤ 1 W
- Case material: Aluminum alloy with Nickel-plating, logo/date code laser engraved.
- Operation temperature: -35C to +85C deg

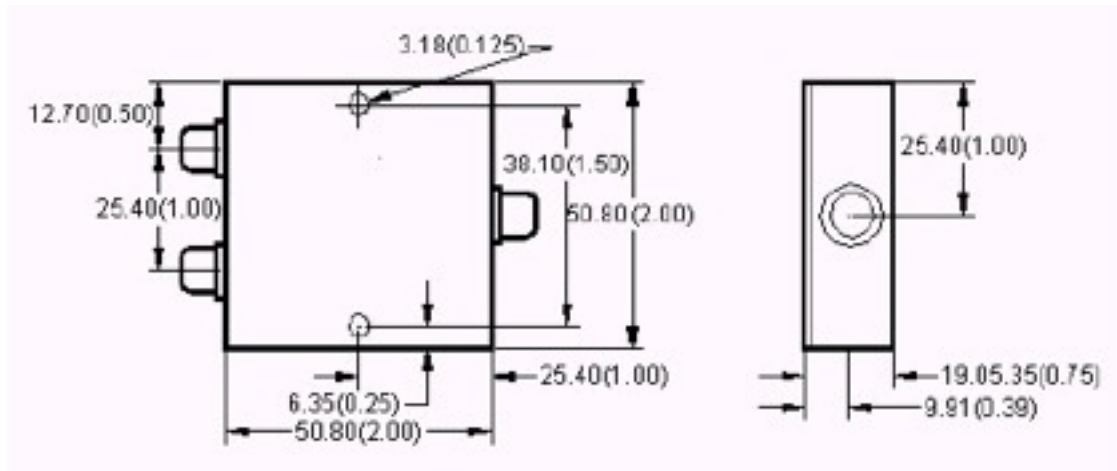

All specifications are subject to change without notice.

Telephone: 978-772-3767

Fax: 978-772-3768

[www.responsemicrowave.com](http://www.responsemicrowave.com)